

Shower Mixer with Bath Divertor

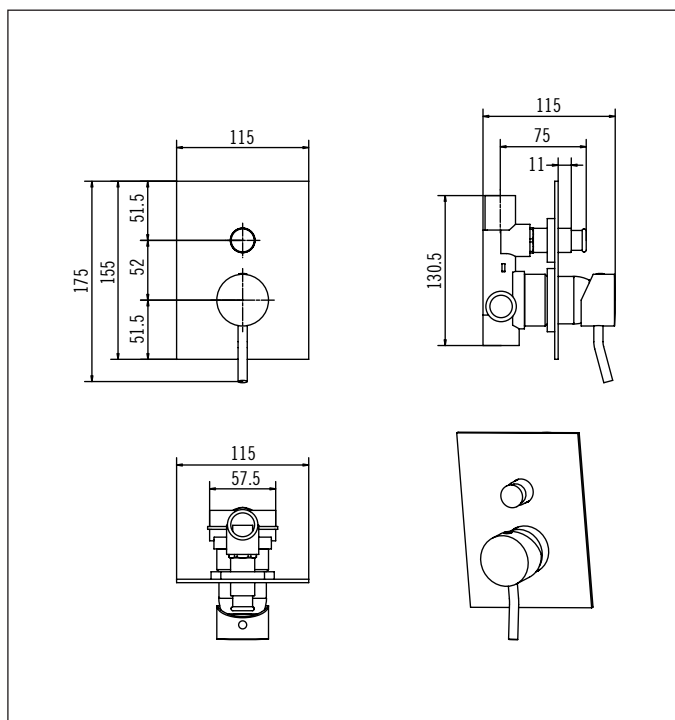

Code: HJ SHMBD

Finish: Chrome

Faceplate Diameter (Rectangular): 115mm x 155mm

Barrel Diameter: 41mm

Divertor barrel diameter: 20.5mm

Centre to centre (mixer to diverter): 51.5mm

Back set: (Mounting board to front of lining):

Minimum: 60mm

Maximum: 75mm

Recommended: 65mm

Installation Hole: Minimum: 85 x 45mm

3 wingbacks supplied (not shown)

Cartridge: Mondo 35K Flat base

Divertor type: Auto

Operation: Push button

Default outlet: Lower 3/4" BSP Female

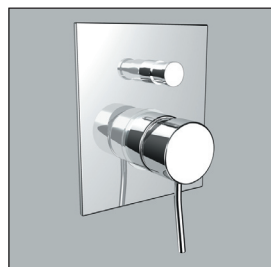

Mains pressure only

Recommended Pressure

Operational Range:

Minimum: 150 kPa

Recommended: 600 kPa

Never to Exceed: 1000 kPa

Maximum Operating

Temperature: 70°C

Aquatica Warranty

Aquatica NZ Limited offer, from the date of purchase, a 2 year warranty on handshowers, a 5 year warranty on tapware and accessories and a lifetime warranty on stainless steel sinks.

Aquatica NZ Limited warrants that only high quality workmanship and materials have been employed in the manufacture of its tapware, accessories and stainless steel products. If any faulty workmanship or materials is proven during the warranty period, Aquatica NZ Limited will at its own cost repair, or at its option replace, the faulty product.

The guarantee is non-transferable and proof of purchase is required.

The use of spray or abrasive cleaners of any kind will void the warranty. (Tapware should only be cleaned with a mild detergent and a soft damp cloth).

Failure to use an in-line strainer or filter on lines to tapware incorporating a ceramic cartridge or ceramic disc mechanism may also void the warranty.

Every effort has been made to show the products as they will be sold, however, all models and specifications are subject to change without notice.

Aquatica NZ Limited

9 Saunders Place,
Avondale, Auckland.

Tel: 09-828 2068,

Fax: 09-828 2069

Email: info@aquatica.co.nz

or visit our website:

www.aquatica.co.nz