

Iso

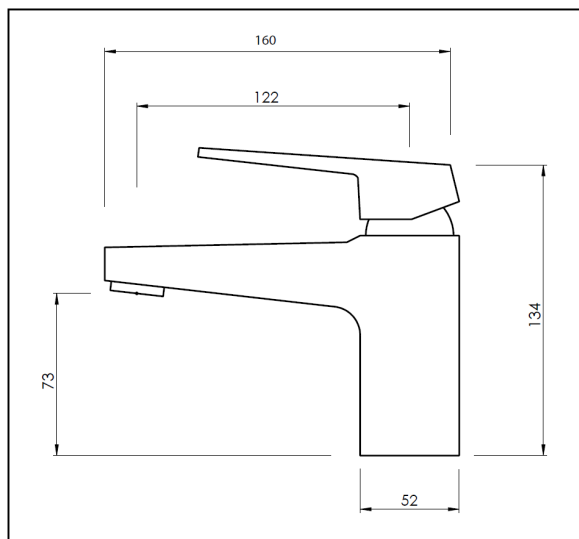

Basin Mixer All Pressure



Suitable all pressures

Recommended Pressure
Operational Range:
Minimum: 35kPa
Recommended: 600kPa
Never to Exceed: 1000kPa
Maximum Operating
Temperature: 70°C

Code: IS BASMAP
Finish: Chrome
Spout: Fixed

Aerator supplied

Stainless Steel Inlet Hoses:

Hot:	Size:	M12 x 1/2" BSP
	Length:	400mm
Cold:	Size:	M10 x 1/2" BSP
	Length:	400mm

Horseshoe washer

Mounting Hardware:	Stud:	6mm x 2
	Nut:	9mm A/F x 2
	Horseshoe Washer:	

Installation Hole Diameter:	Minimum:	30mm
	Maximum:	42mm

Cartridge:	40mm Kerox	Raised Base
------------	------------	-------------

WELS:	Mains pressure	4 Star
	Flow rate	7.5 l/min
	Low/Unequal	3 Star
	Max flow at 35 kPa	9 l/min



Aquatica Warranty

Aquatica NZ Limited offer, from the date of purchase, a 2 year warranty on handshowers, a 5 year warranty on tapware and accessories and a lifetime warranty on stainless steel sinks.

Aquatica NZ Limited warrants that only high quality workmanship and materials have been employed in the manufacture of its tapware, accessories and stainless steel products. If any faulty workmanship or materials are proven during the warranty period, Aquatica NZ Limited will at its own cost repair, or at its option, replace the faulty product.

The guarantee is non-transferable and proof of purchase is required.

The use of spray or abrasive cleaners of any kind will void the warranty. (Tapware should only be cleaned with a mild detergent and a soft damp cloth).

Failure to use an in-line strainer or filter on lines to tapware incorporating a ceramic cartridge or ceramic disc mechanism may also void the warranty.

Every effort has been made to show the products as they will be sold, however, all models and specifications are subject to change without notice.

Aquatica NZ Limited
9 Saunders Place
P O Box 19146
Avondale, Auckland
Tel: 09 828 2068
Fax: 09 828 2069
Email: info@aquatica.co.nz
Or visit our website
www.aquatica.co.nz