

Kudos

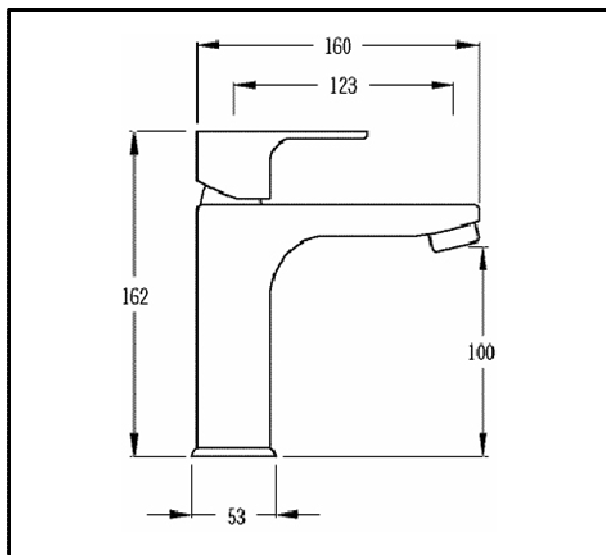

## Basin Mixer



### Mains pressure only

Recommended Pressure  
Operational Range:  
Minimum: 150 kPa  
Recommended: 600 kPa  
Never to Exceed: 1000 kPa  
Maximum Operating  
Temperature: 70°C

Code:	KD BASM	
Finish:	Chrome	
Spout:	Fixed	
Water Outlet:	Standard pressure compensating aerator 7 ℓ/min	
Stainless Steel Inlet Hoses:		
Hot:	Size:	M10 x ½" BSP
	Length:	400mm
Cold:	Size:	M10 x ½" BSP
	Length:	400mm
Base Ring supplied with custom flat seal		
Mounting Hardware:	Stud:	2 x 6mm
	Nut:	9mm A/F
	Horseshoe Washer	
Installation Hole Diameter:	Minimum:	32mm
	Maximum:	36mm
Cartridge:	Mondo 35K	Flat base
Accessories:	Tube spanner Aerator spanner	
WELS:	Mains pressure	4 Star
	Flow rate	7.5 ℓ/min
	Low/Unequal	N/A
	Max flow at 35 kPa	N/A



The stars stars the more water efficient

**WATER RATING**

Water Consumption

**7.5**

litres per minute

Water tested at 3 bar and 10°C



### Aquatica Warranty

Aquatica NZ Limited offer, from the date of purchase, a 2 year warranty on handshowers, a 5 year warranty on tapware and accessories and a lifetime warranty on stainless steel sinks.

Aquatica NZ Limited warrants that only high quality workmanship and materials have been employed in the manufacture of its tapware, accessories and stainless steel products. If any faulty workmanship or materials are proven during the warranty period, Aquatica NZ Limited will at its own cost repair, or at its option, replace the faulty product.

The guarantee is non-transferable and proof of purchase is required.

The use of spray or abrasive cleaners of any kind will void the warranty. (Tapware should only be cleaned with a mild detergent and a soft damp cloth).

Failure to use an in-line strainer or filter on lines to tapware incorporating a ceramic cartridge or ceramic disc mechanism may also void the warranty.

Every effort has been made to show the products as they will be sold, however, all models and specifications are subject to change without notice.

Aquatica NZ Limited  
9 Saunders Place  
P O Box 19146  
Avondale, Auckland  
Tel: 09 828 2068  
Fax: 09 828 2069  
Email: [info@aquatica.co.nz](mailto:info@aquatica.co.nz)  
Or visit our website  
[www.aquatica.co.nz](http://www.aquatica.co.nz)