

Mia

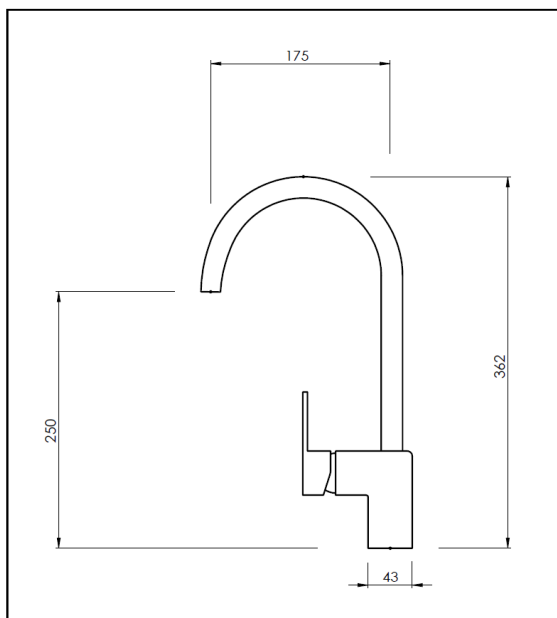

## Sink Mixer Gooseneck



### Mains pressure only

Recommended Pressure

Operational Range:

Minimum: 150 kPa

Recommended: 600 kPa

Never to Exceed: 1000 kPa

Maximum Operating

Temperature: 70°C

Code: MI SM G/NECK  
Finish: Chrome  
Spout: 360° swivel

Aerator supplied

Stainless Steel Inlet Hoses:

Hot: Size: M10 x 1/2" BSP  
Length: 400mm

Cold: Size: M10 x 1/2" BSP  
Length: 400mm

Mounting Hardware: Stud: 1 x 8mm  
Nut: 12mm A/F  
Horseshoe Washer

Installation Hole Diameter: Minimum: 33mm  
Maximum: 43mm

Cartridge: Kerox 35mm Flat base

WELS: Mains pressure 3 Star  
Flow rate 9ℓ/min

Low/Unequal N/A  
Max flow at 35 kPa N/A



### Aquatica Warranty

Aquatica NZ Limited offer, from the date of purchase, a 2 year warranty on handshowers, a 5 year warranty on tapware and accessories and a lifetime warranty on stainless steel sinks.

Aquatica NZ Limited warrants that only high quality workmanship and materials have been employed in the manufacture of its tapware, accessories and stainless steel products. If any faulty workmanship or materials are proven during the warranty period, Aquatica NZ Limited will at its own cost repair, or at its option, replace the faulty product.

The guarantee is non-transferable and proof of purchase is required.

The use of spray or abrasive cleaners of any kind will void the warranty. (Tapware should only be cleaned with a mild detergent and a soft damp cloth).

Failure to use an in-line strainer or filter on lines to tapware incorporating a ceramic cartridge or ceramic disc mechanism may also void the warranty.

Every effort has been made to show the products as they will be sold, however, all models and specifications are subject to change without notice.

Aquatica NZ Limited  
9 Saunders Place  
P O Box 19146  
Avondale, Auckland  
Tel: 09 828 2068  
Fax: 09 828 2069  
Email: [info@aquatica.co.nz](mailto:info@aquatica.co.nz)  
Or visit our website  
[www.aquatica.co.nz](http://www.aquatica.co.nz)