

Sink Mixer with Pull-out Spray

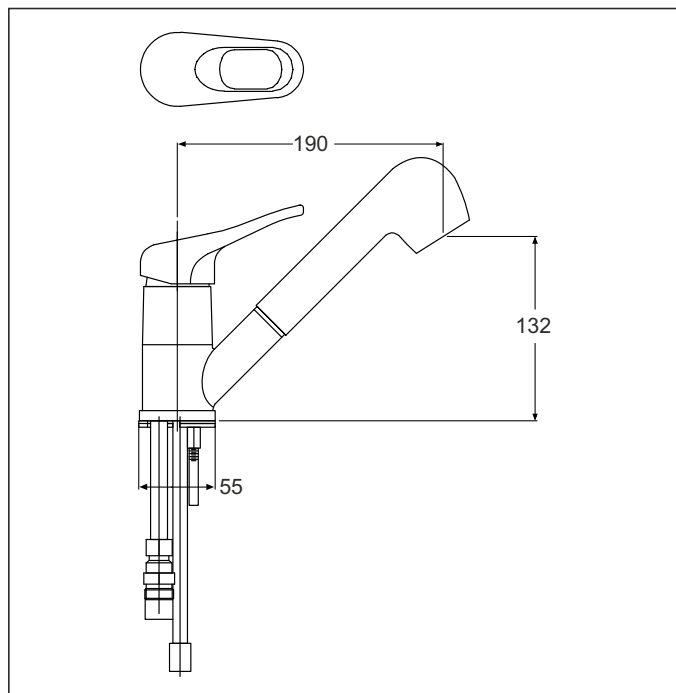

Code:	SG SMPS		
Finish:	Chrome only		
Spout:	Swivel 90°		
Water outlet: Spray or aerated flow			
Stainless Steel Inlet Hoses:			
Hot:	I/D: 9.5mm	Size:	M16 x 1/2" BSP
		Length:	350mm
Cold:	I/D: 6.5mm	Size:	M12 x 1/2" BSP
		Length:	350mm
Spray Hose Internal Diameter:		9mm	
Spray Hose Length:		1.5 metres	
Spray Hose Extendable Length:		Maximum:	1 metre
Metal Base Ring supplied with O-ring seal			
Mounting Hardware:		Studs:	2 x 6mm
		Nut:	9mm A/F
		Horseshoe Washer	
Installation Hole Diameter:		Minimum:	38mm
		Maximum:	44mm
Cartridge:		Mondo 40K	Flat base
Flow control:		PCW 9.0 ltr	

Handy Tip 1: Pull-out hose and counterweight must be free of interference under bench. (If flexi hoses are repeatedly hit, they will fail).

Handy Tip 2: Threaded base ring must be adjusted for correct swivel tension. (i.e. If it is too loose the spout will swing excessively; if excessively tight, it can result in damage to mixer). Not recommended for commercial installations.

Please note: Specifications are subject to change without notice. It is the responsibility of the installer to check the measurements of the physical product before installation.

Suitable for equal and unequal pressure systems

Recommended Operational Pressure Range: 65 - 600 kPa
 Never to Exceed: 1000 kPa
 Maximum Operating Temperature: 80°C

Aquatica Warranty

Aquatica NZ Limited offer the following warranty periods on its range of tapware from the date of purchase.

Residential Use

- Tapware - 5 year warranty
- Handshowers, Shower Roses – 2 year warranty
- Pull-out Sprays and spray heads on Sink Mixer Coils – 2 year warranty
- Commercial tapware – 2 year warranty

Commercial Use

- Tapware - 1 year warranty
- Handshowers, Shower Roses – 1 year warranty
- Pull-out Sprays and spray heads on Sink Mixer Coils – 1 year warranty

Only high quality workmanship and materials have been used in the manufacture of Aquatica's tapware. If any workmanship or material is proven faulty during the warranty period, Aquatica NZ Limited will, at its own cost or option, repair or replace the faulty product.

The warranty is transferable but the original proof of purchase from an authorised Aquatica distributor is required for all claims.

Aquatica's liability will not extend to damage caused by reasonably foreseeable loss such as inappropriate materials in a wet area ie. floating wooden floors.

Waterlines to tapware incorporating a ceramic cartridge or ceramic disc mechanism should have an inline strainer or filter fitted. Absence of these may void the warranty.

Any suspected defect must be notified to Aquatica as soon as possible after discovery. All repair work must be performed by a plumber who has received authorisation from Aquatica prior to proceeding with the work. Aquatica may immediately authorise repair work to be undertaken, however, this is not necessarily acceptance of liability.

Aquatica guarantee that the tapware will be able to handle temperatures up to a maximum of 70°C.

Water pressure up to 1000 kPa is the maximum limit for the tapware. Above this the warranty will become void.

Serial numbers or tags should not be removed from the products as they are essential in establishing warranty.

Aquatica NZ Limited

9 Saunders Place,
 Avondale, Auckland.
 Tel: 09-828 2068,
 Fax: 09-828 2069
 Email: info@aquatica.co.nz
 or visit our website:
www.aquatica.co.nz

© copyright Aquatica 2016

